



"Your Solutions Partner"

Specifications

F.O.B Sedalia, Missouri 65301



G-5-DLSS

OPTIONS:

- 14 gauge tops
- Thermostat, Robertshaw - T-TH
- Special height legs - T-SP-HT-LEGS
- Serving shelves- T956-x, T956-460-x, T956-461-x
- Adaptor plates - T31, T32, T33
- Telescope covers - 546, 548
- 3 bar tray slides - TS3BTS-FX/HD-x
- Solid tray slide - TSOLID-FX/HD-x
- Veneered panels -T-x-P
- Powder coat paint colors
- Designer series food shields - TS530, TS540, TS550, TS560, TS570, TS580

AGENCY LISTINGS:



DUKE MANUFACTURING CO.

2305 N. Broadway
St. Louis, MO 63102

800.735.3853 Toll Free
314.231.1130 In Missouri
314.231.5074 Fax
www.dukemfg.com

Approval Stamp(s):

PRODUCT INFORMATION:

PROJECT: _____

ITEM: _____

QUANTITY: _____

MODEL:

Thurmaduke™ Steamtables

Hot Food Units - Gas - Deluxe

- G-2-DLPG/G-2-DLSS 2 top openings
- G-3-DLPG/G-3-DLSS 3 top openings
- G-4-DLPG/G-4-DLSS 4 top openings
- G-5-DLPG/G-5-DLSS 5 top openings
- G-6-DLPG/G-6-DLSS 6 top openings

TOP:

- One piece, 16 gauge, 300 Series stainless steel
- Top openings die - stamped, 12" x 20"
- Integral carving/work surface

HEAT COMPARTMENTS - dry well only:

- Individual burners
- Individual adjustable gas valves
- Individual galvanized steel radiation plates
- Safety pilots
- Gas pressure regulator for unit
- 3500 BTU/hour per burner
- 676 spillage pans - (1) per compartment
- 12" x 20" stainless steel liner, 8" deep

BODY AND INTERIOR SHELF:

- 300 Series stainless steel or paint grip steel
- End panels die-stamped
- 6" polished stainless steel legs

INTEGRAL DISHSHELF:

- Heavy gauge, one piece stainless steel - 8-1/2" wide
- Housing for control knobs, thermostats and master switch
- Wire knob guards

SHORT FORM SPECIFICATIONS:

Thurmaduke™ Steamtables - Hot Food - Gas - Deluxe. Top shall be constructed of one piece, 16 gauge, 300 Series stainless steel, extended on operator's side to provide integral carving or work surface. Each top opening to be die-stamped with raised beaded edges, measuring 12" x 20", fitted with stainless steel removable spillage pan (#676), as standard. Body to be constructed of 20 gauge, 300 Series stainless steel or paint grip steel with powder coat paint, as specified. Body parts made into panels by forming edges into angles and channels which are welded together to provide structural strength. End panels die-stamped with square corners, side opposite operator fully enclosed. Bottom shelf made of heavy gauge steel, same as body panels, with edges flanged down at back and ends. Bottom shelf has clearance of 15-1/2". Integral dish shelf shall be made of heavy gauge, one piece stainless steel, 8-1/2" wide with rail on operator's side. Canted, easy-to-reach control knobs and housing for valves, manifold, etc. 6-1/2" clearance between bottom edge of work surface and dish shelf. Each heat compartment liner shall be die-formed, 8" deep, fabricated of heavy gauge stainless steel and insulated on all four sides with 1" fiberglass. Each compartment shall have individual burners, rated at 3500 BTU/hour, for use with natural or propane. Safety pilots standard. Burners to be controlled by adjustable gas valve, with adjustable pilot light. Galvanized steel radiation plate shall be furnished in each heat compartment, with gas pressure regulator provided with each unit to eliminate varying flame heights. 6" polished stainless steel legs, adjustable to 7-1/4", to be furnished. **CASTERS NOT AVAILABLE ON GAS UNITS.**



**THURMADUKE™ STEAMTABLES
HOT FOOD UNITS - GAS - DELUXE**

- G-2-DLPG/G-2-DLSS 2 top openings
- G-3-DLPG/G-3-DLSS 3 top openings
- G-4-DLPG/G-4-DLSS 4 top openings
- G-5-DLPG/G-5-DLSS 5 top openings
- G-6-DLPG/G-6-DLSS 6 top openings

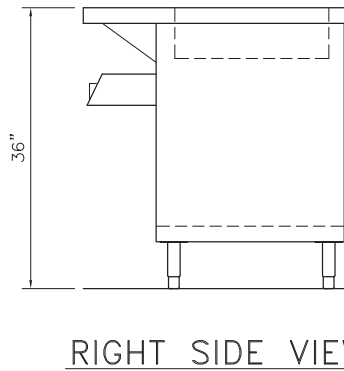
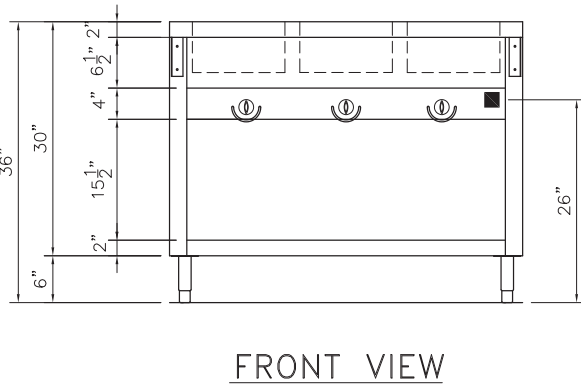
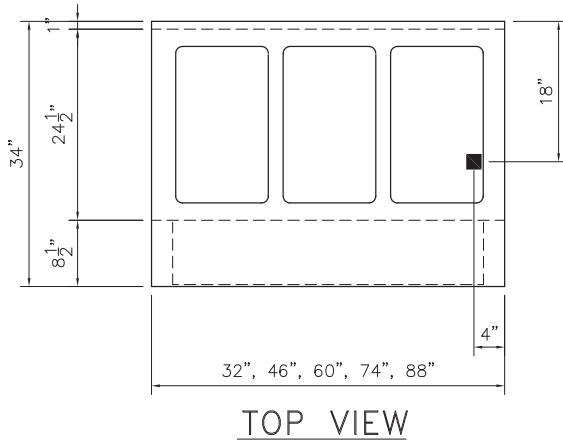

POWER SUPPLY		
Model	# Burners	Total BTU
G-2-DLPG/SS	2	7,000
G-3-DLPG/SS	3	10,500
G-4-DLPG/SS	4	14,000
G-5-DLPG/SS	5	17,500
G-6-DLPG/SS	6	21,000
■ - GAS CONNECTION - 1/2" I.P.S.		

DIMENSIONS:

FREIGHT CLASS: 150

Model		Length		Width		Height		Top Openings	Cube ft. Crated	Weight	
Enameled	Stainless	in.	cm.	in.	cm.	in.	cm.			lbs.	kg
G-2-DLPG	G-2-DLPG	32	81.3	34	86.4	36	91.4	2	27.0	255	115.9
G-3-DLPG	G-3-DLPG	46	116.8	34	86.4	36	91.4	3	38.1	335	152.3
G-4-DLPG	G-4-DLPG	60	152.4	34	86.4	36	91.4	4	49.2	410	186.4
G-5-DLPG	G-5-DLPG	74	188.0	34	86.4	36	91.4	5	60.2	495	225.0
G-6-DLPG	G-6-DLPG	88	223.5	34	86.4	36	91.4	6	71.3	595	270.5

NOTE: Specify natural gas or propane gas when ordering.
For high altitude orifice, specify elevation
Sliding doors NOT available, casters not available

NO combustable materials should be stored on the bottom shelf of gas unit

DUKE MANUFACTURING CO.
2305 N. Broadway
St. Louis, MO 63102

800.735.3853 Toll Free
314.231.1130 In Missouri
314.231.5074 Fax
www.dukemfg.com



"Your Solutions Partner"

Specifications subject to change