

# Carts & Kiosks - 8' Curved Bar

Contact Your Vollrath  
Sales Representative  
for Custom Carts  
& Kiosks!

Carts & Kiosks—8' Curved Bar 75500

Prepainted black or silver ACM  
(aluminum composite material)  
constructed base

- Lightweight and durable
- Safe for outdoor use
- Incredibly strong and allows for unique shapes

Black ACM toe Kick

Polyform foot rest

1" (2.5cm) black bumper  
molding protects walls  
and prolongs life of bar cart



**Option:** Base Options to match any décor

- Custom paint
- Custom laminate covered base (3 sides standard)
- Custom front base graphics to show brands or logos and attract customers

**Optional Features** (Not Shown)

- ACM bulkhead canopy provides attractive option for merchandising brand name while attracting potential customers— options include:
  - Custom graphics
  - Custom paint color to match any décor
  - 2" Adjustable poles— brass or powder coated
  - Track lights with 20A electrical service highlight food or other products
- Under counter GFCI outlet box provides convenient and easy way to plug in appliances for use with bar
  - Lights and other options can be prewired to avoid costly aftermarket electrical wiring
  - Available with 15A or 20A service
- Stainless steel insulated ice bin with sliding cover, 60lb capacity, 27" x 20" x 8" deep
- 5 or 7 1/2 gallon waste water tank for easy way to collect waste water and empty it
- Stainless steel ice bin with drain and cover, 45lb capacity 21 1/4" x 15 1/4"
- Bottle opener and cap catcher

Black polyform countertops  
(NSF certified) are durable  
and easy to clean

**Option:** Full size ice pan  
with false bottom and cover  
provides convenient storage  
for ice while keeping gray  
water away from ice—cover  
for added sanitation

Polyform integral speed rails  
(NSF certified) are strong,  
durable and easy to clean—black color  
eliminates staining—3 each (24")

Eight 5" heavy-duty non-marking  
swivel casters for smooth and  
easy movement without leaving  
scuff marks—6 Swivel and 2  
Swivel with brakes



Shown with optional Formica  
Choco-figured Mahogany (#6933-43)



Optional Umbrella



Optional Canopy



Setting  
the Standard™

# Carts & Kiosks - 8' Curved Bar

## 75500 8' Curved Bar

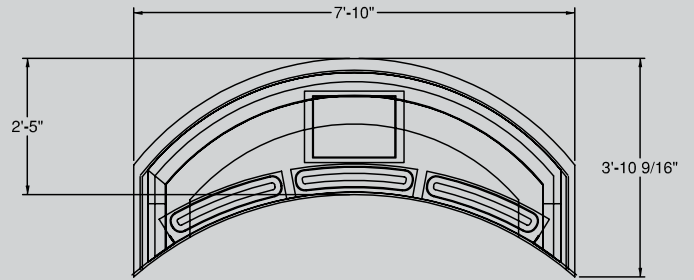

TOP VIEW

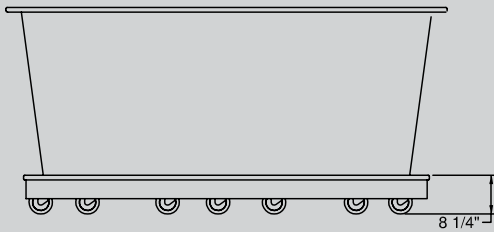

FRONT VIEW

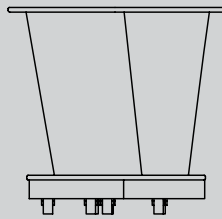

SIDE VIEW

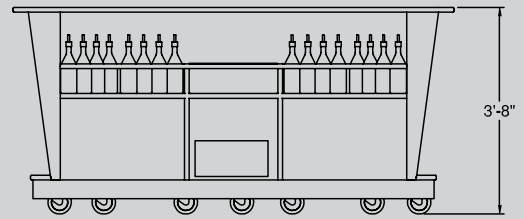

BACK VIEW

**NOTES**

1) Electrical Service



The Vollrath Company, L.L.C.  
 1236 North 18th Street  
 Sheboygan, WI 53082-0611 USA  
 Customer Service: 800.628.0830  
 Equipment Service: 800.628.0832  
 Main PH: 920.457.4851  
 Fax: 920.459.6573  
 Form L35616 Rev 7/06



Setting  
the Standard™