

Item No. _____

Quantity _____



BEVERAGE-AIR

Commercial Refrigeration Equipment General Specifications

Whenever space is a limiting factor and health inspection approval is critical, compact, shallow-depth refrigerators and freezers have provided the answer. Single door refrigerator and matching freezer are only 20" wide by 21" deep. Overall, height on 6" legs supplied is 31". Two-door companion refrigerator is 34" wide by 23" deep.

Models feature construction with stainless steel exteriors and anodized aluminum interiors. Doors are mounted on gravity self-closing hinges with 120° stay open position. Magnetic door gaskets are used to accomplish positive door sealing. Two epoxy coated wire shelves are provided behind each door.

UCR27SD, shallow depth refrigerator model is the choice of many manufacturers of specialty carts and kiosks. It is constructed along the same specs as the compact models but is larger in depth (27") and width (27") and height (34-1/2") on 6" legs.

All of the shallow depth models feature front breathing under doors to accommodate location in confined areas. Balanced refrigeration systems provide refrigerator-holding temperatures in the 35° to 38° range. Freezer model temperature is held below zero. Freezer model includes automatic electric defrosting. Refrigerants used are R134a in the refrigerators and 404A in the freezer. Both are CFC free providing full compliance with environmental concerns.

Cabinet insulation is foamed-in-place polyurethane for maximum energy conservation and structural integrity. It also is CFC free in providing compliance with environmental concerns.

SHALLOW DEPTH UNDERCOUNTER REFRIGERATORS AND FREEZER FOOD PREPARATION SERIES

MODELS:
UCR20
UCF20
UCR34
UCR27SD



UCR / UCF20



UCR34



UCR27SD



Made in USA

<http://www.Beverage-Air.com>

<http://CCR.Carrier.com>



BEVERAGE-AIR

P.O. Box 5932, Spartanburg, S.C. 29304-5932
1-800-845-9800

FAX# 864-582-5083

Model Specified _____ Store# _____

Location _____ Quantity _____



BEVERAGE-AIR

Shallow Depth Undercounter Refrigerators/Freezers

Models: UCR20 / UCF20 / UCR34 / UCR27SD

MODEL	UCR20	UCF20	UCR34	UCR27SD
DIMENSIONAL DATA				
Net Capacity (cubic ft.)	2.7	2.7	5.5	6.2
Net Capacity (liters)	76	76	156	175
Length overall (inches)	20"	20"	34"	27"
Length overall (mm)	508	508	864	685
Depth overall - Less handle	21"	21"	21"	27 ³ / ₄ "
Depth overall (mm) - Less handle	584	584	584	685
Height overall - on 6" legs	31"	31"	31"	34 ¹ / ₂ "
Height overall - on 6" legs (mm)	787	787	787	622
Depth with door open 90° (inches)	39 1/2"	39 1/2"	37 1/4"	51 3/8"
Clear Door Opening (inches)	16 x 18 1/2	16 x 18 1/2	16 x 18 1/2	22 1/2 x 21 1/2
Number of shelves	2	2	4	2
Number of doors	1	1	2	1
ELECTRICAL DATA				
Full load amperes 115/60/1	3.5	6.5	4.0	4.0
Full load amperes 220/50/1	-	-	-	-
REFRIGERATION DATA				
Refrigerant	R134a	404A	R134a	R134a
Horsepower	1/6	1/4	1/5	1/6
WEIGHT DATA				
Gross Weight (Crated lbs)	111	119	158	157
Gross Weight (Crated kg)	50	54	72	71

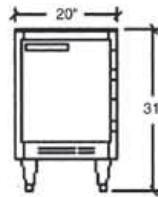

UCR/UCF-20 Front

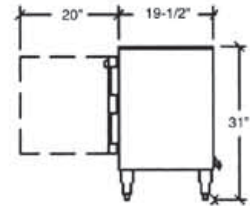

UCR/UCF-20 End

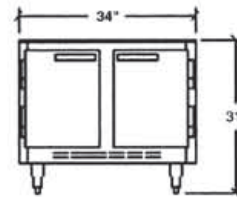

UCR-34 Front

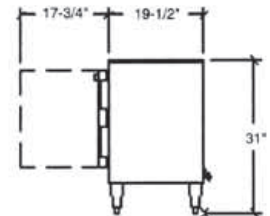

UCR-34 End

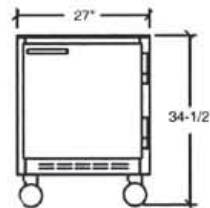

UCR-27SD Front

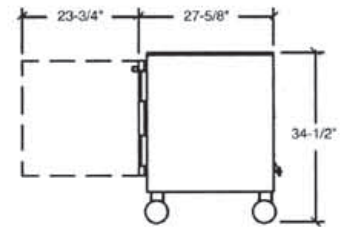

UCR-27SD End



Available From:



BEVERAGE-AIR

PO Box 5932 • Spartanburg, SC • 29304 • USA
 1-800-845-9800 • Fax No. 1-864-582-5083
www.Beverage-Air.com