



BEVERAGE-AIR

SPE SERIES

FOOD PREPARATION SERIES

mega top

Item no. _____

Quantity _____



SPE27_12M



SPE48_18M



SPE60_24M



SPE72_30M

SPE SERIES "MEGA" SANDWICH UNITS

Fifty percent greater pan capacity than the all around standard prep table. Features enhanced refrigeration system and new and improved grille system for better airflow and less temperature gradient. Improved design provides better airflow management and uniform temperature distribution throughout the cabinet. Pans are cooled from the bottom, eliminating the necessity of air blanket. Airflow assures that product in open containers is kept below 41°F and above freezing. This translates into increased product shelf life, higher quality food, better food appearance, fresher product and a reduction of bacteria build-up to combat food-borne illnesses

CABINET CONSTRUCTION

Exterior construction includes heavy-duty stainless steel finish on front, sides, top, door(s) and grille. Removable hood and insulated lid assembly are made of matching stainless steel. Cabinet back and bottom are constructed of galvanized steel. Interior liner is made of anodized aluminum for superior resistance to corrosion.

Doors are mounted to face of cabinet on gravity hinges permitting them to self close under their own weight. Hinges also allow doors to stay open 120 degrees and permit easy door removal for service and cleaning if required. A plug in type vinyl magnetic gasket is attached to each door for positive seal. Door handle is made from extruded aluminum with a black anodized finish. It is contoured to permit easy opening of doors with fingers from both top and bottom of handle.

Cabinet insulation is CFC free foamed-in-place polyurethane of two-inch minimum thickness. Six-inch casters, 2 with brakes, are standard. Legs are available as an option. An 8' cord set is provided with 115-volt models.

Cutting board supplied with cabinet is 10" wide constructed of high-density white polyethylene plastic. It is readily removable for cleaning. Two epoxy-coated steel wire shelves are supplied behind each door. Shelves are adjustable in 2" increments. Pans furnished are 4" deep and made of polycarbonate plastic. Units will accommodate six-inch deep pans.

REFRIGERATION

More robust refrigeration system provides added capacity and efficiency. Systems are designed using CFC free R134a refrigerant and capillary tube between condenser and evaporator. Recirculated, forced air from evaporator is moved under pans, which are recessed 2" from top of cabinet. Forced air over the condenser is drawn through grilles under door(s) as well as the back and bottom of cabinet. Automatic condensate evaporator is provided to eliminate the need of floor drains.

FEATURES

- Available in 27", 48", 60", and 72" widths
- 36" working height
- Stainless steel exterior (front and sides)
- Pans, 10" cutting board and 6" legs are standard
- Interior finish is anodized aluminum. Epoxy coated steel shelves are standard
- Removable hood and lid assembly
- Energy efficient forced-air refrigeration system circulates cold air under and slightly over the pans
- Lift-out refrigeration system



SPE SERIES FOOD PREPARATION mega top

Item no. _____

Quantity _____

SPE27-M, SPE48-M, SPE60-M, SPE72-M MEGA TOP SANDWICH UNITS

SPECIFICATIONS

MODEL	CRATED WEIGHT	F.O.B.	DOORS	FINISH	CU. FT.	OVERALL EXT. INCHES W x D x H	OVERALL EXT. METRIC (mm) W x D x H	VOLT-S	AMPS	HP	SHELVES	STANDARD PANS 4" DEEP
SPE27-12M	205	BR	1	S/S	7.3	27" x 34" x 45 1/2"	686 x 864 x 1156	115	4.0	1/6	2	9-1/6 size 3-1/9 size
SPE27-12M-09	205	BR	1	S/S WITH LOCKS	7.3	27" x 34" x 45 1/2"	686 x 864 x 1156	115	4.0	1/6	2	9-1/6 size 3-1/9 size
SPE27-12M-23	205	BR	1	S/S WITH 3" CASTERS	7.3	27" x 34" x 42 1/2"	686 x 864 x 1080	115	4.0	1/6	2	9-1/6 size 3-1/9 size
SPE27-12M-24	205	BR	1	S/S WITH LEFT HINGE DOOR	7.3	27" x 34" x 45 1/2"	686 x 864 x 1156	115	4.0	1/6	2	9-1/6 size 3-1/9 size
SP27-12M-32	205	BR	1	S/S WITH DOOR THERMOMETER	7.3	27" x 34" x 45 1/2"	686 x 864 x 1156	115	4.0	1/6	2	9-1/6 size 3-1/9 size
SPE48-12M	300	BR	2	S/S	13.9	48" x 34" x 45 1/2"	1219 x 864 x 1156	115	4.5	1/5	4	6-1/6 size 2-1/2 size
SPE48-12M-09	300	BR	2	S/S WITH LOCKS	13.9	48" x 34" x 45 1/2"	1219 x 864 x 1156	115	4.5	1/5	4	6-1/6 size 2-1/2 size
SP48-12M-32	300	BR	2	S/S WITH DOOR THERMOMETER	13.9	48" x 34" x 45 1/2"	1219 x 864 x 1156	115	4.5	1/5	4	6-1/6 size 2-1/2 size
SPE48-18M	302	BR	2	S/S	13.9	48" x 34" x 45 1/2"	1219 x 864 x 1156	115	4.5	1/5	4	6-1/6 size 2-1/2 size 1 full size
SP48-18M-09	302	BR	2	S/S WITH LOCKS	13.9	48" x 34" x 45 1/2"	1219 x 864 x 1156	115	4.5	1/5	4	6-1/6 size 2-1/2 size 1 full size
SPE48-18M-24	302	BR	2	S/S WITH LEFT HINGE DOOR	13.9	48" x 34" x 45 1/2"	1219 x 864 x 1156	115	4.5	1/5	4	6-1/6 size 2-1/2 size 1 full size
SPE48-18M-32	302	BR	2	S/S WITH DOOR THERMOMETER	13.9	48" x 34" x 45 1/2"	1219 x 864 x 1156	115	4.5	1/5	4	6-1/6 size 2-1/2 size 1 full size
SPE60-12M	338	BR	2	S/S	17.1	60" x 34" x 45 1/2"	1524 x 864 x 1156	115	7.0	1/4	4	6-1/6 size 2-1/2 size
SPE60-18M	360	BR	2	S/S	17.1	60" x 34" x 45 1/2"	1524 x 864 x 1156	115	7.0	1/4	4	6-1/6 size 2-1/2 size 1 full size
SPE60-24M	363	BR	2	S/S	17.1	60" x 34" x 45 1/2"	1524 x 864 x 1156	115	7.0	1/4	4	12-1/6 size 2-1/2 size 1 full size
SPE72-12M	402	BR	3	S/S	21.5	72" x 34" x 45 1/2"	1829 x 864 x 1156	115	7.5	1/4	6	6-1/6 size 2-1/2 size
SPE72-18M	418	BR	3	S/S	21.5	72" x 34" x 45 1/2"	1829 x 864 x 1156	115	7.5	1/4	6	6-1/6 size 2-1/2 size 1 full size
SPE72-24M	402	BR	3	S/S	21.5	72" x 34" x 45 1/2"	1829 x 864 x 1156	115	7.5	1/4	6	12-1/6 size 2-1/2 size 1 full size
SPE72-30M	430	BR	3	S/S	21.5	72" x 34" x 45 1/2"	1829 x 864 x 1156	115	7.5	1/4	6	18-1/6 size 2-1/2 size 1 full size
SPE72-30M-32	430	BR	3	S/S WITH DOOR THERMOMETER	21.5	72" x 34" x 45 1/2"	1829 x 864 x 1156	115	7.5	1/4	6	18-1/6 size 2-1/2 size 1 full size
SPE72-30M-49	430	BR	3	S/S WITH NO PANS	21.5	72" x 34" x 45 1/2"	1829 x 864 x 1156	115	7.5	1/4	6	18-1/6 size 2-1/2 size 1 full size

DIMENSIONS

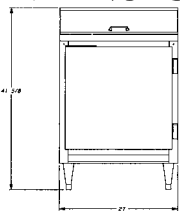

SP27M FRONT VIEW

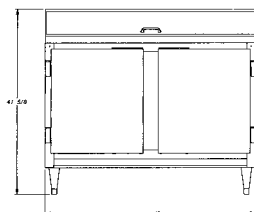

SP48M FRONT VIEW

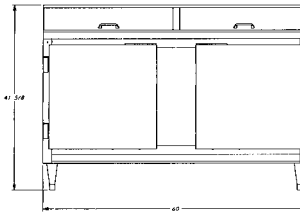

SP60M FRONT VIEW

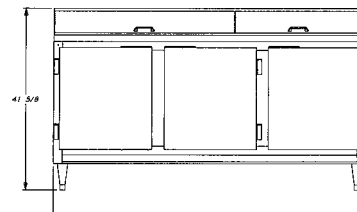

SP72M FRONT VIEW

