



Our main ingredient is value

8512

8512

# MAX<sup>TM</sup> AUTOMATIC SLICER

NEW! EXTRA WIDE 1 3/16" CUT

The Univex #8512 is a heavy duty 12" gear driven automatic slicer with a 1/2 hp motor and a net weight of 108 lbs. Weight and horsepower play an important role in slicing. Cheese, in particular, demands both horsepower and weight for continued production of precision slices. The Univex 8512 slices at a rate of 35 strokes per minute providing both stability and precision slicing. A redesigned slice control mechanism now allows slices up to 1 3/16" thick. As with all Univex slicers, the 8512 comes equipped with a German hollow ground cutting blade and built in sharpener. An easily accessible switch arm can convert the 8512 from automatic to manual operation.



## WARRANTY

The MAX model 8512 Slicer carries a one-year, on-site parts and labor warranty against any flaws in materials and workmanship. This period begins with the date of purchase and, provided the unit is used properly in accordance with our instructions, is in full effect for one year from that date. Any work to be performed under this warranty must be performed between the hours of 8:00 a.m. and 5:00 p.m. local time, Monday through Friday. Univex will not pay overtime charges for work performed other than during normal business hours. Damages incurred in transit or from installation error, accident, alteration or misuse are not covered. Transit damages should be reported to the carrier immediately. Univex shall not be liable for any consequential, compensatory, incidental, or special damages. Contact Univex Service Department for any warranty claims.



UNIVEX CORPORATION ■ 3 Old Rockingham Road ■ Salem, NH 03079-2140  
Tel 603-893-6191 ■ Fax 603-893-1249 ■ E-mail [univex@univexcorp.com](mailto:univex@univexcorp.com)  
TOLL-FREE ORDERING FAX 1-800-356-5614  
[www.univexcorp.com](http://www.univexcorp.com)

April 2005  
Printed in USA

## NEW EXTRA WIDE 1 3/16" CUT

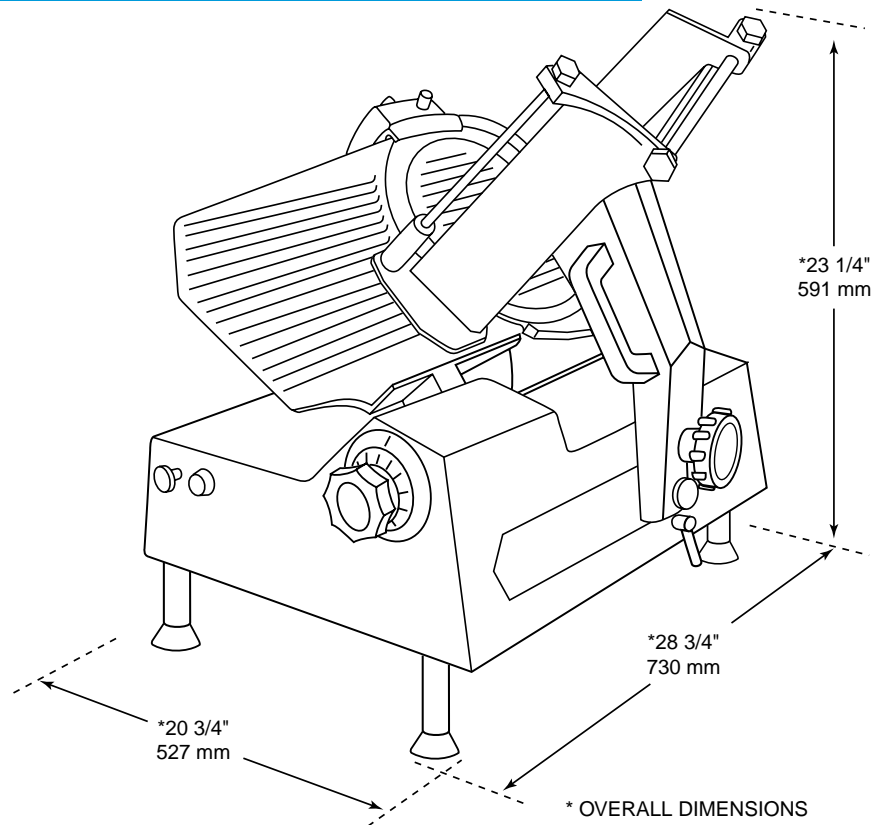

8512

### SPECIFICATIONS

<b>ELECTRICAL:</b>	115/60/1* - 5.4 AMPS *Consult Price List or factory for special voltages
<b>MOTOR:</b>	1/2 HP Capacitor start, capacitor run, 1725 RPM
<b>SPEED:</b>	Carriage (35 strokes per minute) Blade Speed = 280 rpm
<b>BLADE DIAMETER:</b>	12 inches
<b>CARRIAGE:</b>	Gear driven, permanently lubricated with automatic clutch
<b>FINISH:</b>	Polished Anodized Aluminum
<b>STANDARD EQUIPMENT:</b>	German hollow ground hardened steel, high carbon chrome plated blade. Built in sharpener. Pilot Light indicating Knife and Motor (ON). Heavy duty multi-position Meat Holder
<b>OPTIONAL ACCESSORIES:</b>	Vegetable Chute
<b>BODY DIMENSIONS:</b>	16 1/4" (413mm) wide, 24" (610mm) long and 21 1/4 (540mm) high
<b>NET WEIGHT:</b>	108 lbs. (49kg)
<b>SHIPPING WEIGHT:</b>	129 lbs. (58kg)
<b>BOX DIMENSIONS:</b>	26" (660mm) high, 32 1/2" (826mm) wide, 26" (660mm) long