



T&S BRASS AND BRONZE WORKS, INC.
 2 SADDLEBACK COVE / P.O. BOX 1088 / TRAVELERS REST, SC 29690
 PHONE 800-476-4103 FAX 864- 834-3518



Model No.

B-1255M50

Item No.:

Job Name:

Architect/Engineer Approval:

Notes:

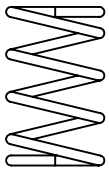

000894-45
 SPRING
 (2 SUPPLIED)



003199-45
 HANDLE SCREW
 (1 SUPPLIED)

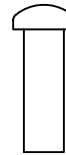

003198-45
 HANDLE NUT
 (1 SUPPLIED)

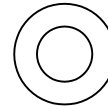

000974-45
 BONNET WASHER
 9/32" I.D. [7mm]
 1/2" O.D. [13mm]
 (2 SUPPLIED)

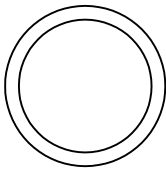

001062-45
 O-RING
 11/16" I.D. [17mm]
 3/4" O.D. [19mm]
 (2 SUPPLIED)

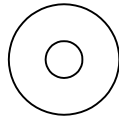

009650-45
 SEAT WASHER
 3/16" I.D. [5mm]
 9/16" O.D. [14mm]
 (2 SUPPLIED)

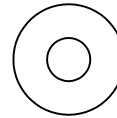

001100-45
 STEM PACKING
 7/32" I.D. [6mm]
 9/16" O.D. [14mm]
 (2 SUPPLIED)

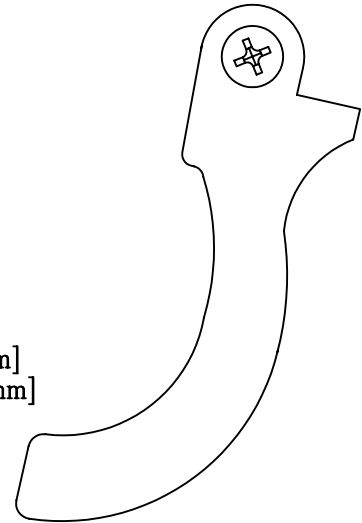

001145-45
 BLUE LEXAN LEVER ARM
 (1 SUPPLIED)



012665-45
 SILICON GREASE TUBE
 (1 SUPPLIED)

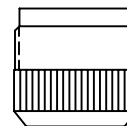

003090-45
 BLUE LEXAN OUTLET TIP
 (1 SUPPLIED)

Product Description:

Drawn:

Checked

Scale:

TEH

JKD

1' = 1'

Approved

Date:

MVW

10-23-01

REPLACEMENT PARTS KIT FOR GLASS FILLER
 (MASTER PACK - QUANTITY 50)