



F18VD

Component Crafted Versa Drawer™

Project _____
 Item _____
 Quantity _____
 CSI Section 11400
 Approved _____
 Date _____

F18VD: VERSA DRAWER™

Models

- F18VD50 50" Versa Drawer with (2) 32" drawers
- F18VD82 82" Versa Drawer with (4) 32" drawers



F18VD50

Standard Features

- 4 temperature operation—each drawer is completely independent and can operate as a refrigerator, freezer, chiller or thaw cabinet at any time
- Easy to use microprocessor control with push button function selection
- HACCP electronic record keeping, alarm notifications, and service diagnostics
- Heavy-gauge stainless steel top with 2"x4" backsplash is standard
- Standard on 6" adjustable legs
- Mechanical access on compressor end of unit
- 32" heavy duty full extension drawers with (2) 12"x20" pan capacity per drawer
- NSF 7 certified
- High density polyurethane foam throughout
- Dart style quick change gaskets
- 8' long electrical cord
- Environmentally friendly HFC-404A refrigerant
- One year parts, one year labor and 5 year compressor warranty

Options & Accessories

- Casters
- 34" ADA height
- Overstructures
- Stainless steel end
- 230/50/1 electrical

Specifications

Exterior Top: Constructed of one-piece heavy-gauge stainless steel with integral 2.12" (5.4cm) high square nosing at front and 2" (5.1cm) x 4" (10.2cm) backsplash at rear.

Exterior Sides, Back and Bottom: heavy-gauge stainless steel side with removable stainless steel mechanical access panel on compressor end. Back, bottom and other end are constructed of galvanized steel.

Interior: Interior of each drawer section is a polyethylene rotocast liner with ABS drawer front liners

Drawers: Heavy-gauge stainless steel exterior front, with a thermoformed ABS plastic interior liner. Frame and tracks are constructed of 11 and 12-gauge stainless steel. Roller track assemblies have self-lubricating Delrin™ rollers.

Refrigeration System: Environmentally friendly HFC-404A refrigerant. Each independent drawer has its own evaporator coil with expansion valve. Digital control acts as thermometer, thermostat and diagnostic center for each drawer. Hot gas defrost system is also utilized during thaw operation.

Electrical Connections: 115 volt, 60 Hertz, single phase. Unit is wired to a J-box and must be hardwired to the power source in the field.

Installation: Units built into chef counters or production centers must accommodate 24" of clearance on compressor end for service access.

The Delfield Versa Drawer is a unique food holding device that includes an open food container disposed within a refrigerated cabinet such that both the container and interior of the cabinet are exposed to the same refrigerated environment, thereby eliminating the need for conventional dual environment systems which refrigerate food disposed within insulated, closed containers, while maintaining the interior of the cabinet at ambient temperature.



MARK7
Custom Systems

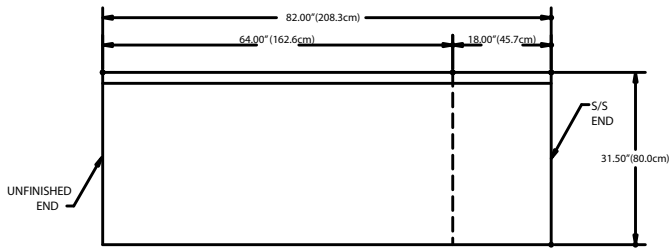

PLAN VIEW
F18VD82

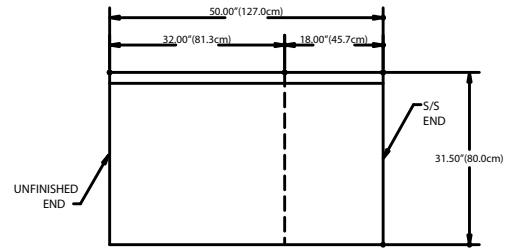

PLAN VIEW
F18VD50

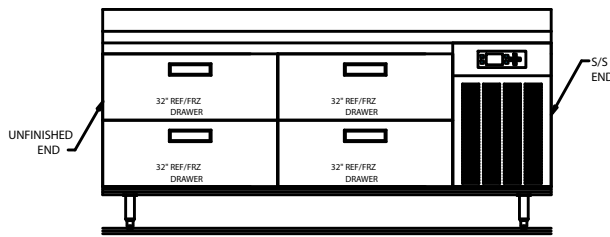

FRONT VIEW
F18VD82

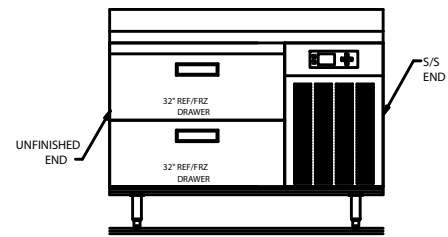

FRONT VIEW
F18VD50

Installation Note: Units built into chef counters or production centers must accommodate 24" of clearance on compressor end for service access.

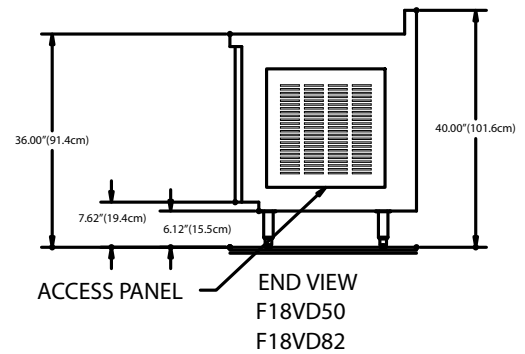

END VIEW
F18VD50
F18VD82

Specifications

Model Number	Overall			32" Drawers	12"x20" Pans	H.P.	Voltage	Amps	Nema Plug	Ship Weight	Energy Consumption
	L	D	H								
F18VD50	50"	31.5"	36"	2	4	1/3	115	6.0	5-15	520	1.50*/4.01**
F18VD82	82"	31.5"	36"	4	8	(2) 1/3	115	12.0	5-15	720	3.0*/8.02**

*All drawers refrigerators.
** All drawers freezers.