



# STAINLESS STEEL ECONOMY WORK TABLES



ELAG & SLAG Series  
Flat Top



FLAG & SFLAG Series  
1 1/2" Backsplash



ELAG & SLAG "M" Series  
Flat Top w/ two Undershelves



KLAG Series  
5" Backsplash

Item #: \_\_\_\_\_ Qty #: \_\_\_\_\_

Model #: \_\_\_\_\_

Project #: \_\_\_\_\_



Stainless Steel Bullet Feet  
standard on SLAG & SFLAG Series



Plastic Bullet Feet standard on  
ELAG, FLAG & KLAG Series

## FEATURES:

**ELAG & SLAG** Top is furnished with 1 5/8" square bend on sides and 1 5/8" sanitary rolled rim on front and rear and square sides.

**ELAG & SLAG "M" Series** Has above features and includes two undershelves.

**FLAG & SFLAG** Top is furnished with 1 5/8" square bend on sides and 1 5/8" sanitary rolled rim on front and square sides, and 1 1/2" backsplash on rear.

**KLAG** Top is furnished with 1 5/8" square bend on sides and 1 5/8" sanitary rolled rim on front and square sides, and 5" back-splash on rear.

Two hat-channels stud welded under table-top to reinforce and maintain a level work surface.

Aluminum die cast "leg-to-shelf" clamp secures shelf to leg eliminating unsightly nuts and bolts. Undershell is fully adjustable.

## CONSTRUCTION:

All TIG welded. Exposed weld areas polished to match adjacent surface.

Top is sound deadened.

Roll formed embossed galvanized hat channels are secured to top by means of structural adhesive and weld studs.

Gussets welded to support hat channels.

## MATERIAL:

### ELAG, ELAG "M", FLAG & KLAG SERIES:

**TOP:** Heavy gauge stainless steel type "430" series.

**SHELF:** 18 gauge galvanized steel.

**LEGS:** 1 5/8" diameter tubular galvanized steel. Galvanized steel gussets. 1" adjustable plastic bullet feet.

### SLAG, SLAG "M" & SFLAG SERIES:

**TOP:** Heavy gauge stainless steel type "430" series.

**SHELF:** 18 gauge stainless steel.

**LEGS:** 1 5/8" diameter tubular stainless steel. Stainless steel gussets. 1" adjustable stainless steel bullet feet.

## FLAT TOP - ELAG & SLAG SERIES

W	L	Single Undershell		Two Undershelves		Single Undershell		Two Undershelves	
		WT.		WT.		WT.		WT.	
24"	30"	ELAG-240	49 lbs.	-		SLAG-240	49 lbs.	-	
	24"	ELAG-242	31 lbs.	-		SLAG-242	31 lbs.	-	
	36"	ELAG-243	64 lbs.	-		SLAG-243	64 lbs.	-	
	48"	ELAG-244	79 lbs.	-		SLAG-244	79 lbs.	-	
	60"	ELAG-245	92 lbs.	-		SLAG-245	92 lbs.	-	
	72"	ELAG-246	109 lbs.	-		SLAG-246	109 lbs.	-	
30"	96"	ELAG-248	145 lbs.	-		SLAG-248	145 lbs.	-	
	30"	ELAG-300	65 lbs.	-		SLAG-300	65 lbs.	-	
	36"	ELAG-303	72 lbs.	-		SLAG-303	72 lbs.	-	
	48"	ELAG-304	89 lbs.	ELAG-304M	107 lbs.	SLAG-304	89 lbs.	SLAG-304M	107 lbs.
	60"	ELAG-305	107 lbs.	ELAG-305M	125 lbs.	SLAG-305	107 lbs.	SLAG-305M	125 lbs.
	72"	ELAG-306	125 lbs.	ELAG-306M	166 lbs.	SLAG-306	125 lbs.	SLAG-306M	166 lbs.
	96"	ELAG-308	166 lbs.	-		SLAG-308	166 lbs.	-	

## 1-1/2" SPLASH FLAG & SFLAG SERIES

W	L	Single Undershell		Single Undershell	
		WT.		WT.	
24"	30"	FLAG-240	49 lbs.	SFLAG-240	49 lbs.
	24"	FLAG-242	31 lbs.	SFLAG-242	31 lbs.
	36"	FLAG-243	64 lbs.	SFLAG-243	64 lbs.
	48"	FLAG-244	79 lbs.	SFLAG-244	79 lbs.
	60"	FLAG-245	92 lbs.	SFLAG-245	92 lbs.
	72"	FLAG-246	109 lbs.	SFLAG-246	109 lbs.
30"	96"	FLAG-248	145 lbs.	SFLAG-248	145 lbs.
	30"	FLAG-300	65 lbs.	SFLAG-300	65 lbs.
	36"	FLAG-303	72 lbs.	SFLAG-303	72 lbs.
	48"	FLAG-304	89 lbs.	SFLAG-304	89 lbs.
	60"	FLAG-305	107 lbs.	SFLAG-305	107 lbs.
	72"	FLAG-306	125 lbs.	SFLAG-306	125 lbs.
	96"	FLAG-308	166 lbs.	SFLAG-308	166 lbs.

## 5" SPLASH KLAG SERIES

W	L	Single Undershell	
		WT.	
24"	30"	KLAG-240	49 lbs.
	24"	KLAG-242	31 lbs.
	36"	KLAG-243	64 lbs.
	48"	KLAG-244	79 lbs.
	60"	KLAG-245	92 lbs.
	72"	KLAG-246	109 lbs.
30"	96"	KLAG-248	145 lbs.
	30"	KLAG-300	65 lbs.
	36"	KLAG-303	72 lbs.
	48"	KLAG-304	89 lbs.
	60"	KLAG-305	107 lbs.
	72"	KLAG-306	125 lbs.
	96"	KLAG-308	166 lbs.



**NEW YORK**  
(800) 645-3166  
Fax: (631) 242-6900

**GEORGIA**  
(800) 832-1218  
Fax: (770) 775-5625

**TEXAS**  
(800) 527-0353  
Fax: (972) 932-4795

**NEVADA**  
(800) 446-8684  
Fax: (775) 972-1578

For Assistance with  
Smart Modifications & Accessories Call:



1-800-498-6634 Fax: 631-586-2933  
smartfab@advancetabco.com

# DETAILS and SPECIFICATIONS

TOL  $\pm$  .500"

ALL DIMENSIONS ARE TYPICAL

## SLAG & ELAG SERIES - Flat Top

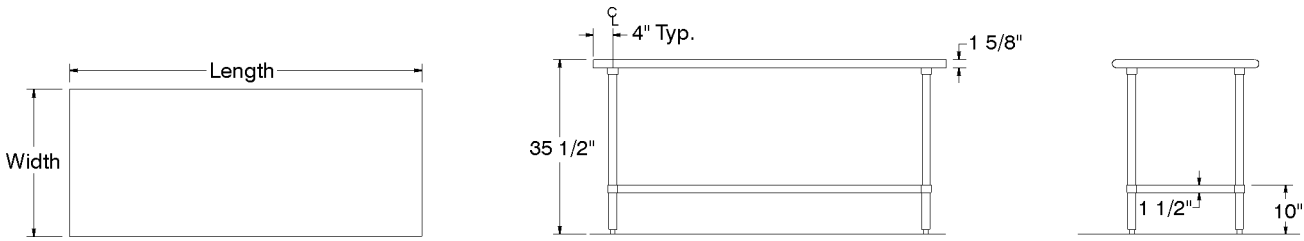

## SLAG & ELAG "M" SERIES - Flat Top with Two Adjustable Undershelves

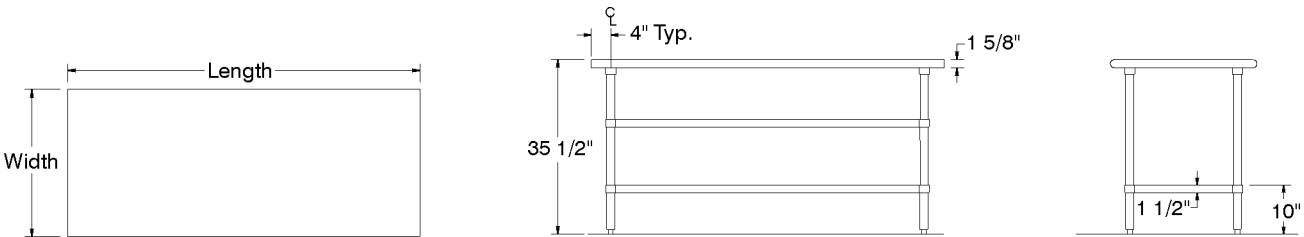

## SFLAG SERIES & FLAG SERIES - 1 1/2" Backsplash

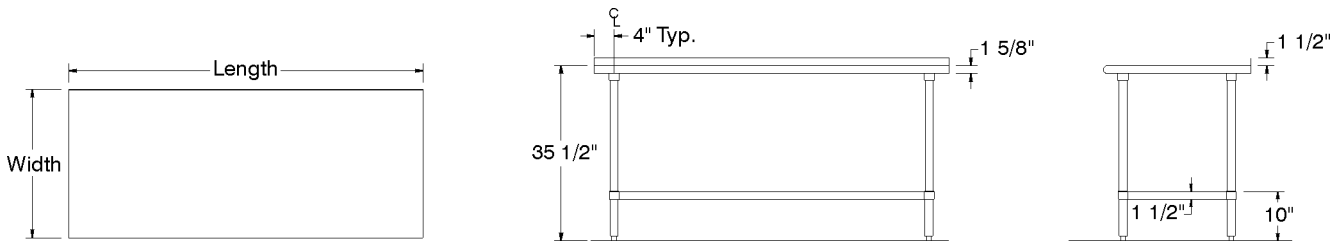

## KLAG SERIES - 5" Backsplash

